

User Manual

SOLAR WALL LIGHT

Special Note:

1. Do not install the lamp against the sun, under the shadow or between two buildings whose height above the lamp. Otherwise, it will lead to insufficient absorption of sunlight and insufficient brightness and time.
2. Do not use the lamp in the environment temperature above 45°C or below 0°C, otherwise will cause the rapid attenuation of the battery and affect on the battery life, even damage.
3. Do not use the non-standard installation accessories to install the lamp, otherwise, any accident is caused will be borne by the installer.
4. Please charge the product every 3 months to ensure the activity of the lithium battery.
5. If you have storage the product for over one year, please do fully charge and discharge inspection and make sure the battery is in good condition. Otherwise, it is forbidden to use!

Warning:

1. Keep the device away from fire and oil to avoid any fire or explosion;
2. No one except professional technicians should attempt to disassemble the light to avoid damaging the light;
3. It is strictly forbidden to disassemble the battery for personal use;
4. If the lamp doesn't get charged for 3 days, the battery maybe out of power, and you have to charge it under bright sunlight;
5. To ensure that the lamp works in an ideal state for a long time, please clean the solar panel regularly according to the local dust conditions, the suggestion is one time at least half a year;
6. Long-term static storage of the product for over one year will cause the inside battery damage or even leakage, if the battery is leaking, it will cause the battery to ignite if by sun charge suddenly.

SOLAR WALL LIGHT

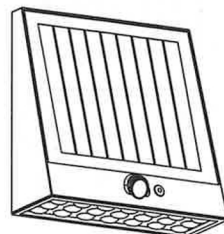

Solar Power



Ray Sensor



Waterproof

Main Parts

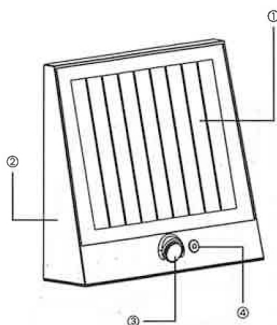

- ① Solar Panel
- ② Lamp Body
- ③ PIR
- ④ Switch Button

Characteristics

Battery: Li-ion Battery
Solar panel: Monocrystalline silicon
Materials: ABS+PC

How to install the device?

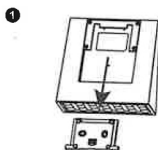

Take off the bracket from the lamp body

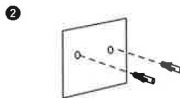

Drilling and embedding the expansion screws into the wall



Fix the bracket by screws onto the wall

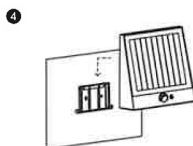

Hang the lamp body on the bracket

Working process instructions



Switch Button

1. Switch on and off: long press for 1.5S
2. Short press to change the lighting mode

Lighting Mode

- M1: 25%(250lm) till dawn
- M2: 10%(100lm)+PIR (30S)
- M3: 0+PIR (30S)
- M4: 100%(1000lm) till dawn